

★ **YODER SMOKERS** ★  
PREMIUM GRILLS & SMOKERS

# S-SERIES PELLET GRILLS ROTISSERIE INSTALLATION MANUAL

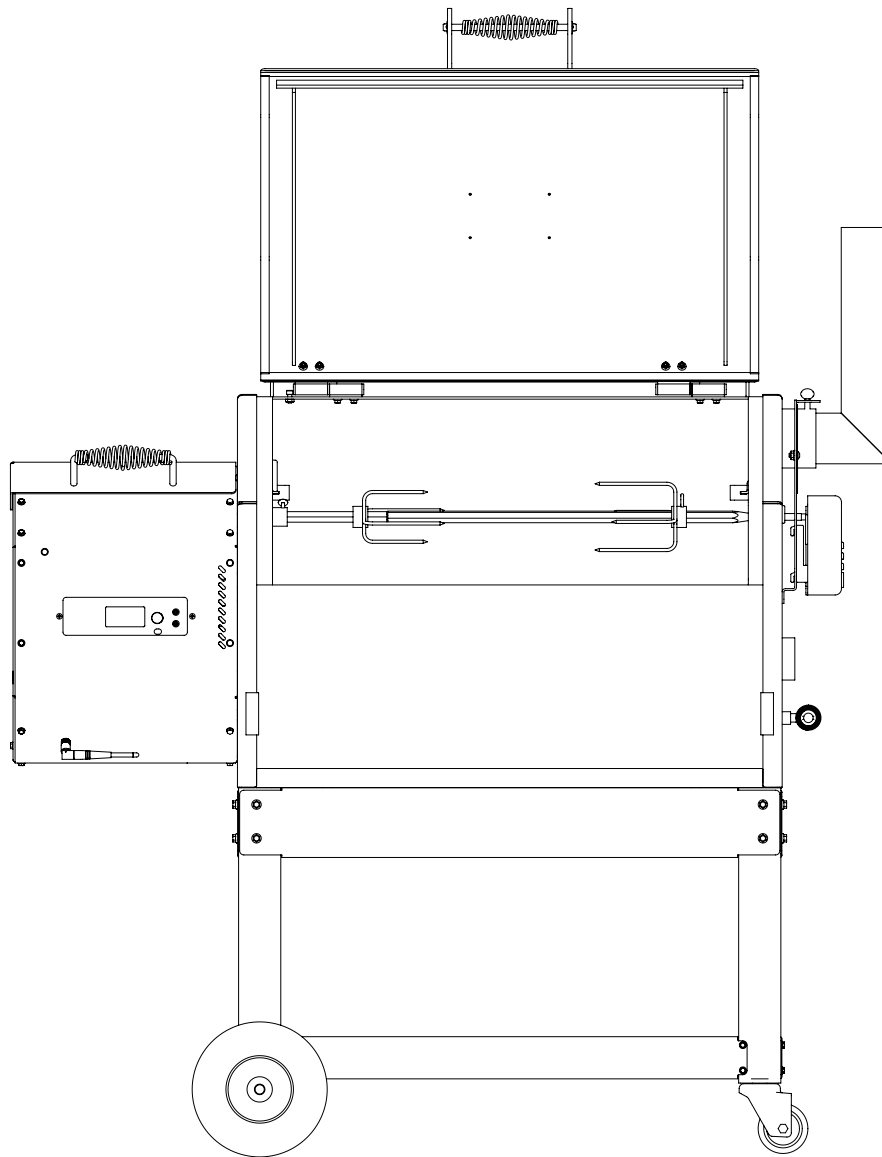



# ★ YODER SMOKERS ★

## PREMIUM GRILLS & SMOKERS

---

### BEFORE YOU GET STARTED

Begin by confirming all the parts included in this kit are accounted for in this kit. *Should any items be missing, please contact Customer Service for assistance at 877.409.6337 or [customerservice@yodersmokers.com](mailto:customerservice@yodersmokers.com)*



### PARTS INCLUDED

(1) Three-piece Spit Rod   (2) Spit Rod Forks   (2) Bushings   (1) Motor  
(1) “Stack” Bracket with Adapter   (1) Motor Bracket   (2) Hanger/Rail Brackets   (1) Thumbscrew  
(4) 1/4” Hex Nuts   (4) 1/4” Cap Screws   (1) Step Drill Bit   (1) Silicon Plug

---

### TOOLS YOU’LL NEED

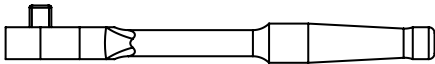
9/16” Socket Wrench | 9/16” Socket | 9/16” Wrench | 7/32” Hex Key

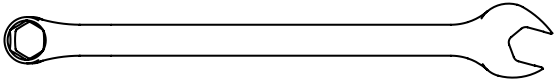
SOCKET WRENCH	
9/16" SOCKET	
7/32" HEX KEY	
9/16" WRENCH	

# DRILLING THE HOLE

## STEP 01

Use the drilling template to mark the hole location beneath the smokestack. Drill a small pilot hole. Enlarge with the provided step drill bit until it reaches  $\frac{3}{4}$ -inch diameter (final size is marked on the bit). **Safety Warning: Always wear eye protection and gloves when drilling.**

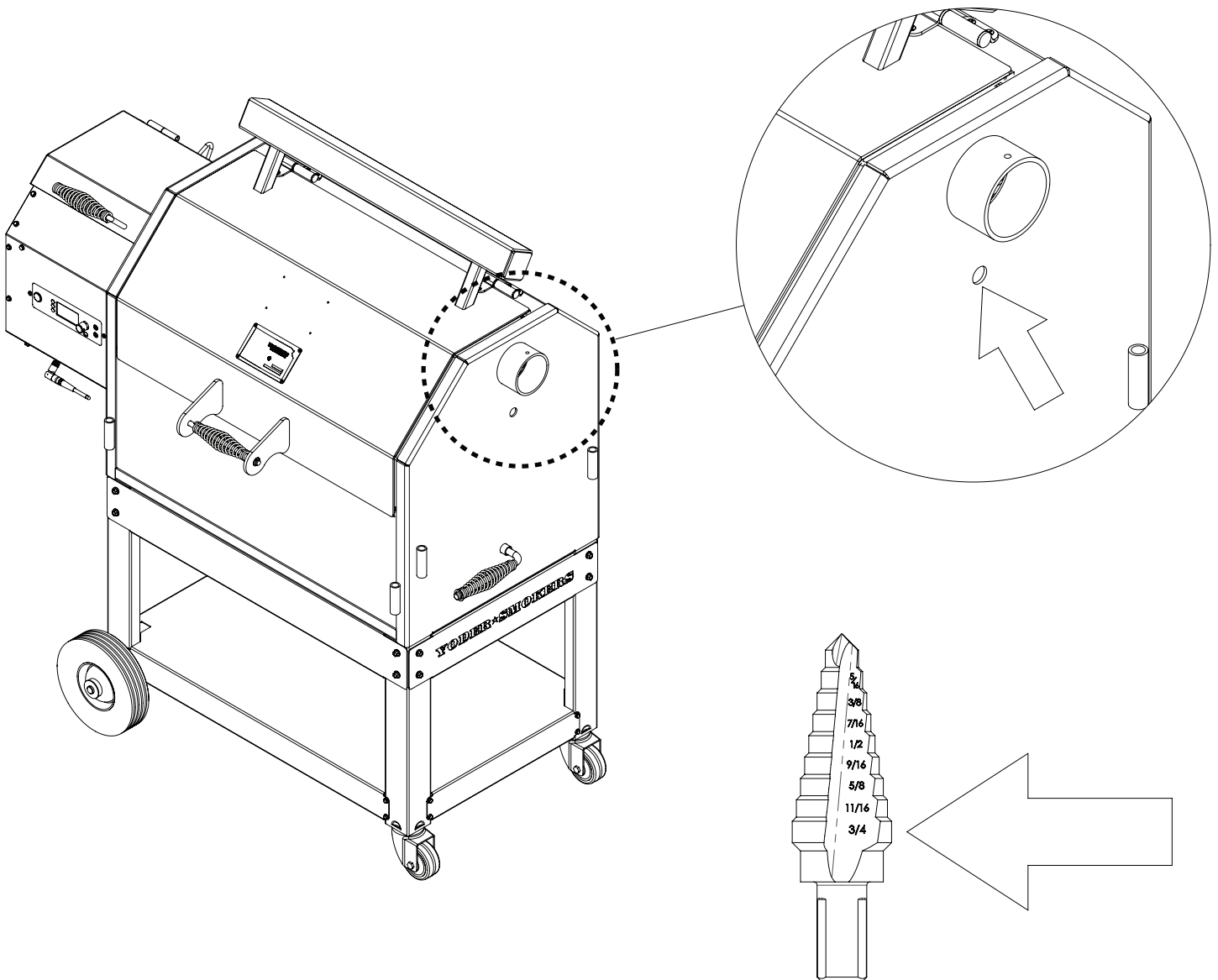

# INSTALLING THE MAIN BRACKET

## STEP 02

*Install the main bracket according to your grill model:*

*- YS480/YS640: Leave the reducer plate in position.*

*- YS1500S/Cimarron: Remove the reducer plate.*

*Reinsert the smokestack and secure it with the thumbscrew.*

*Remove cooking grates before proceeding*

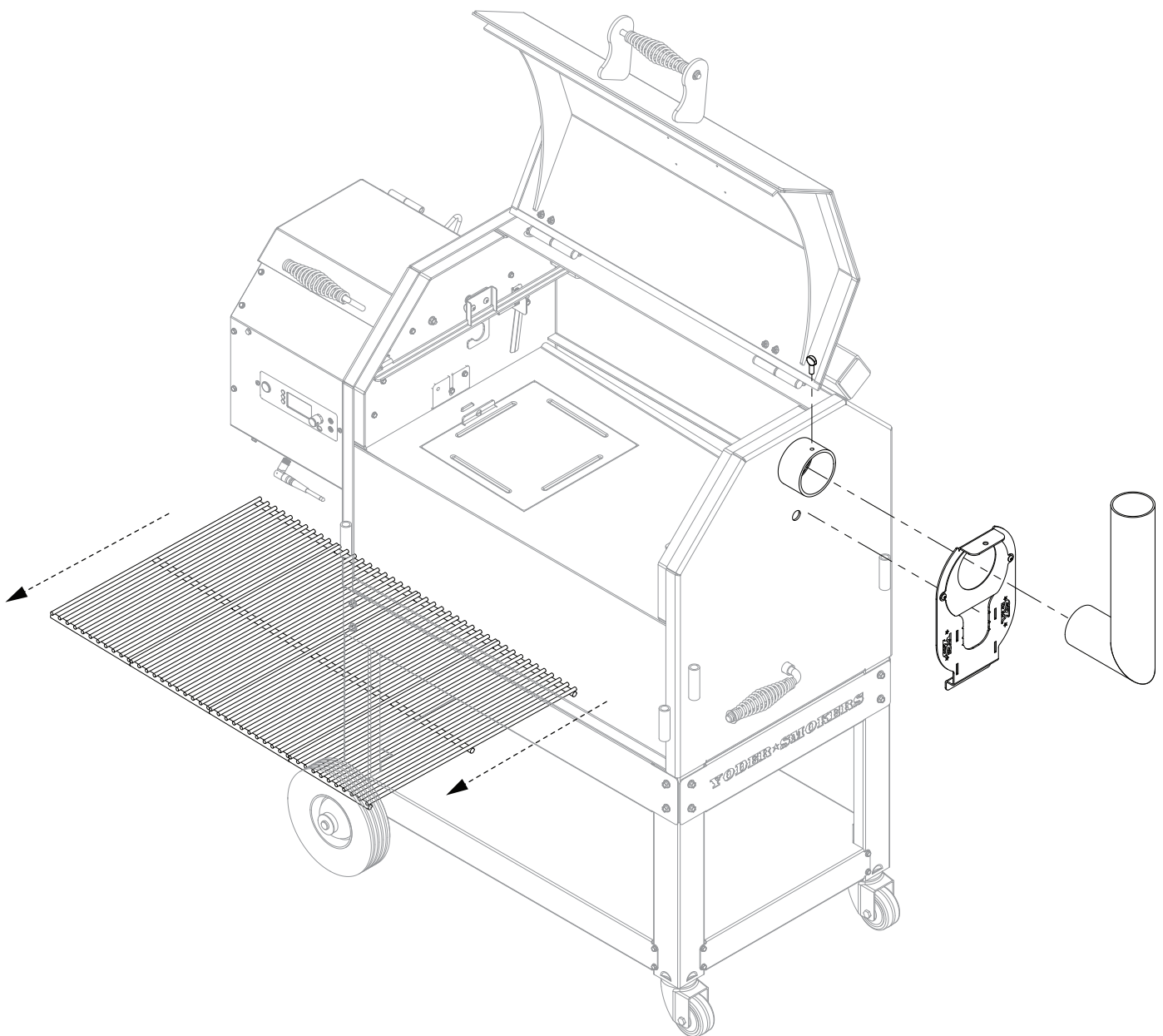

# ASSEMBLING THE SPIT ROD

## STEP 03

*D*Select rod sections based on your grill model (see chart). Place a copper washer between sections and tighten with a wrench—just enough to slightly compress the washer.

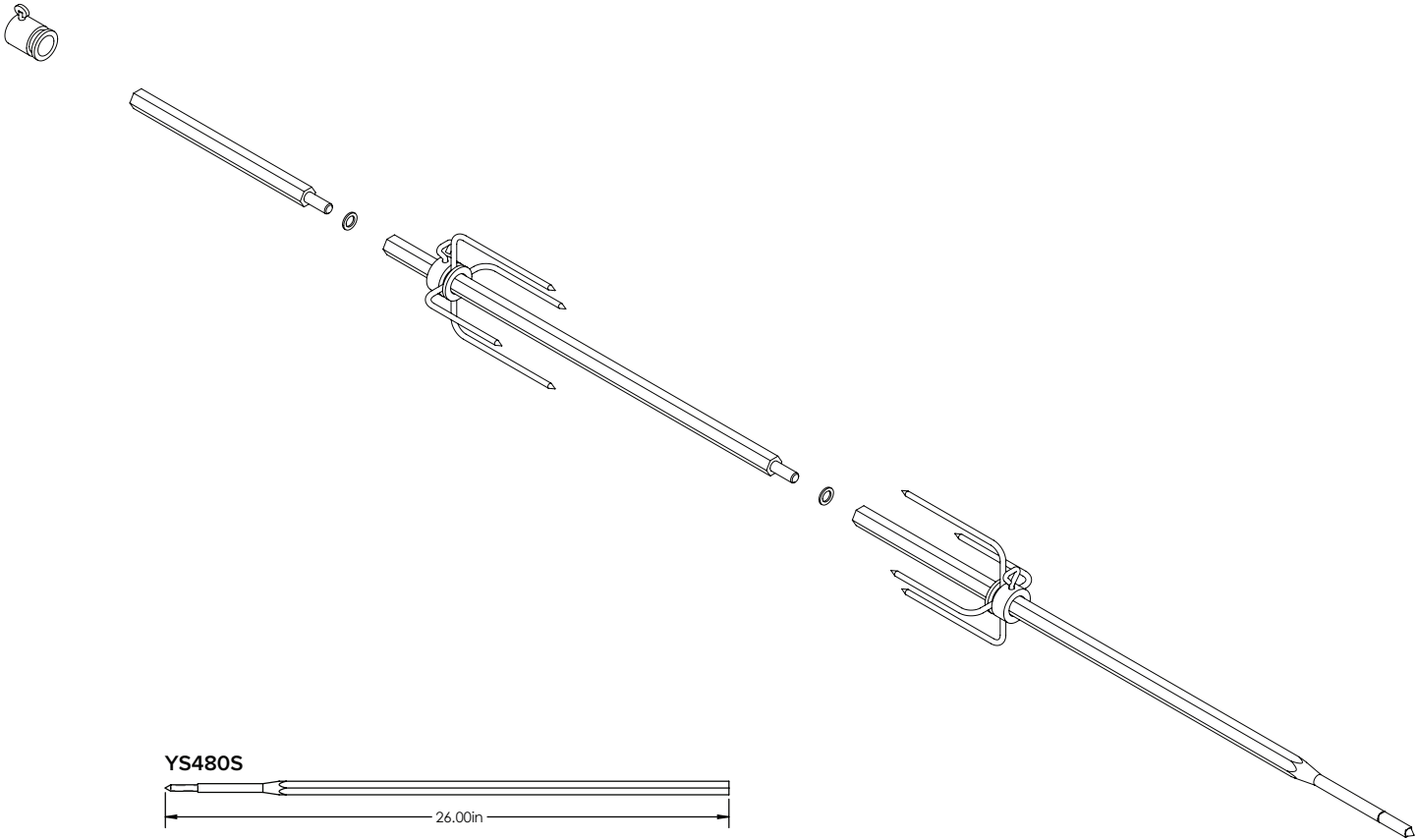

**YS480S**

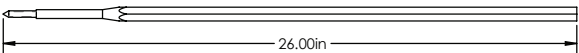

**YS640S**

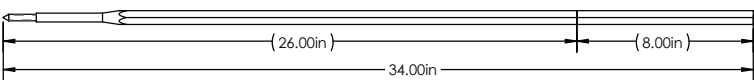

**YS1500S**

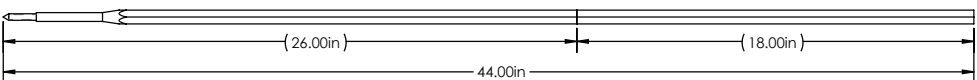

**CIMARRON**

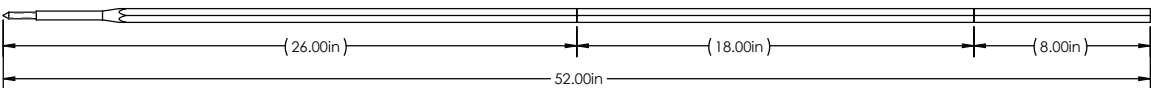

# INSTALLING SPIT BRACKET

## STEP 04

*Install the spit hanger bracket centered on the second shelf rail, opposite the smokestack. Hook should face the front of the grill. Leave the thumbscrew loose until the spit rod is in place. Choose the correct hanger for your grill model (YS480/640 vs. YS1500/Cimarron).*

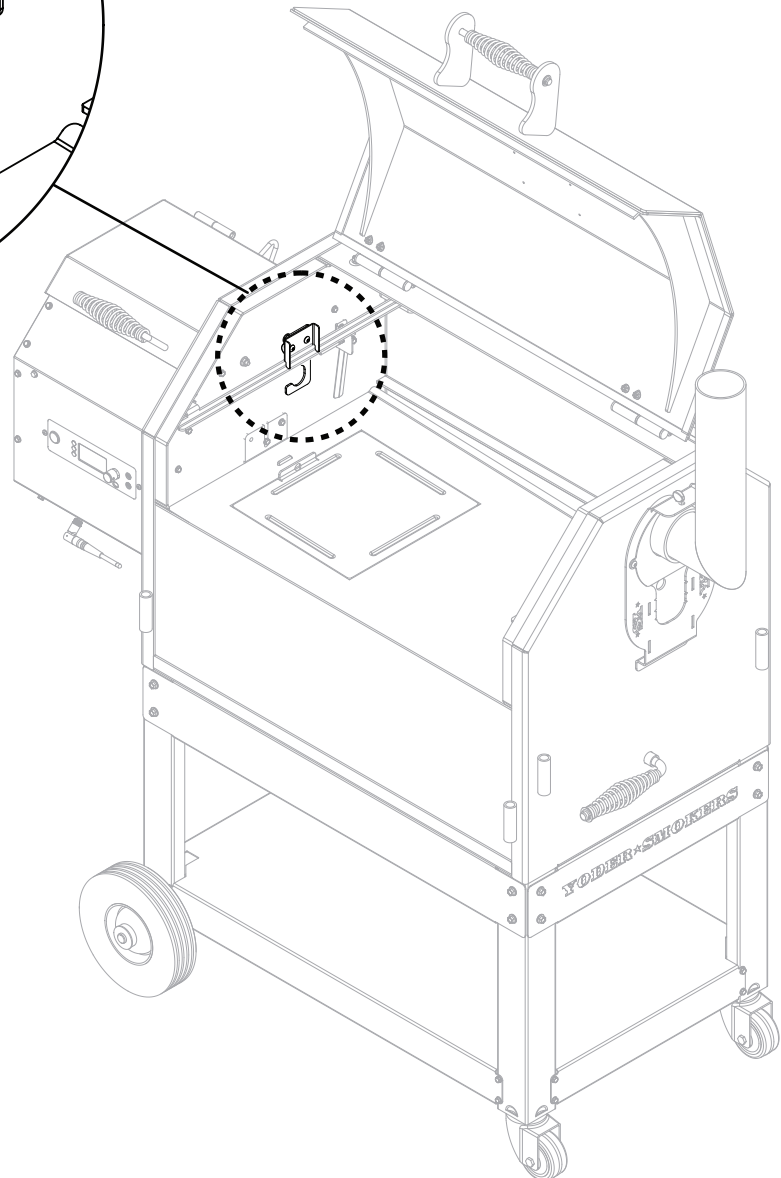
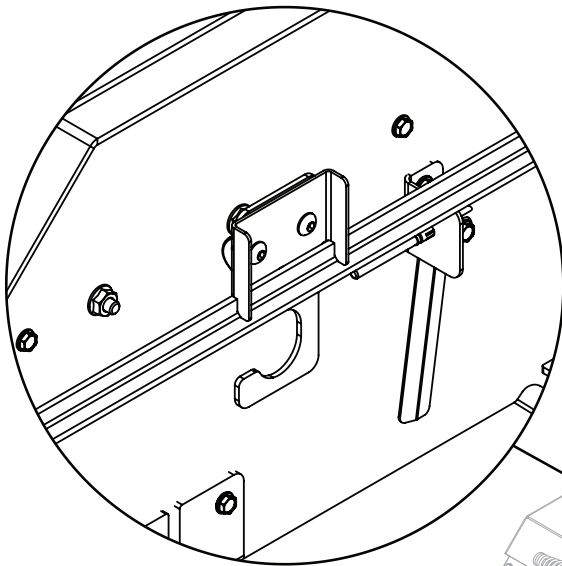

### SPIT HANGERS

YS480  
YS640

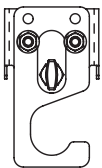

YS1500  
CIMARRON

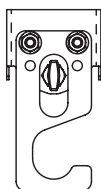

# INSTALLING THE SPIT ROD

## STEP 05

Load food onto the spit rod, secure with forks, and tighten thumbscrews. Slide a bushing onto the non-pointed end but do not tighten yet. Insert the pointed end through the cooking chamber hole. Rest the bushing on the hanger hook and tighten the thumbscrew by hand. **Note: Ensure forks are fully tightened to prevent slippage.**

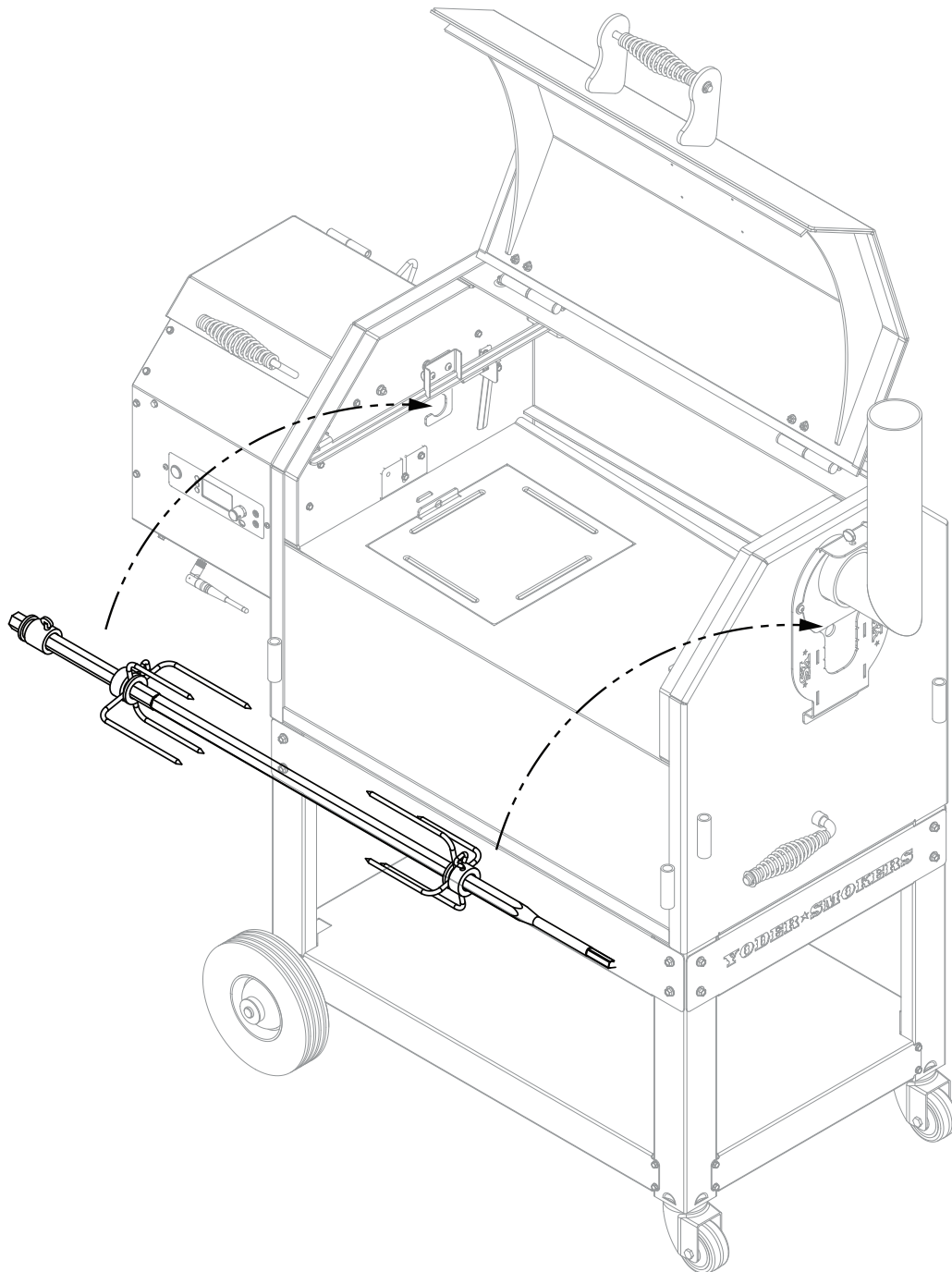



# INSTALLING THE MOTOR

## STEP 06

*Slide the motor onto the motor bracket with hooks facing downward. Insert motor bracket tabs into slots on the main bracket and press down to lock. Insert spit rod fully into motor coupling, then tighten the bushing thumbscrew. **Caution: Keep the motor cord away from hot surfaces and moisture.***

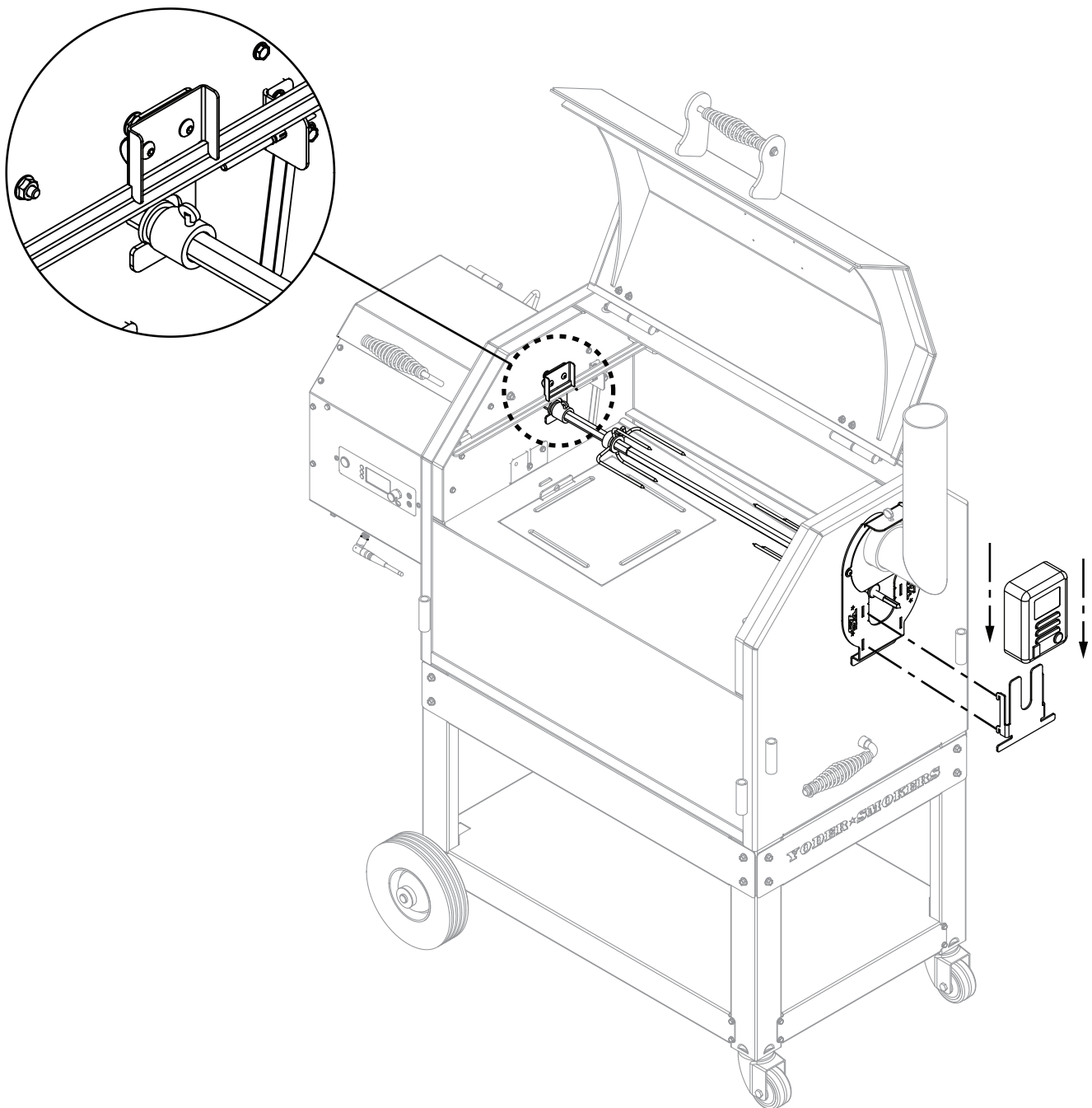

**INSTALLATION COMPLETE**  
YOUR ROTISSERIE IS NOW READY FOR USE.





**FOR PRODUCT SUPPORT:**  
**CustomerService@YoderSmokers.com**  
**877.409.6337 (OPTION 2)**

**★ YODER SMOKERS ★**  
**PREMIUM GRILLS & SMOKERS**